

SE-311 INVITATION FOR MINOR CONSTRUCTION QUOTES

AGENCY: TCL - Technical College of the Lowcountry

PROJECT NAME: TCL - Beaufort Welding Lab

PROJECT NUMBER: H59-N283-ML CONSTRUCTION COST RANGE: \$25,000 to \$35,000

PROJECT LOCATION: Beaufort Mathers Campus-Bldg 15

DESCRIPTION OF PROJECT: *(450 character limit)*

TCL is requesting bids to reconfigure existing electrical wiring in welding lab to accommodate new welding booth and equipment layout.

QUOTE DUE DATE: 08/01/2024

TIME: 10:00 AM

AGENCY PROJECT COORDINATOR: Sam Dellorso

EMAIL: sdellorso@tcl.edu

TELEPHONE: (843) 525-8329

DOCUMENTS OBTAINED FROM: Architecture 101

DOCUMENT DEPOSIT AMOUNT: \$0.00 IS DEPOSIT REFUNDABLE: Yes No N/A

PERFORMANCE BOND REQUIRED? Yes No PAYMENT BOND REQUIRED? Yes No

Contractors must obtain Documents/Plans from the above listed source(s) to be listed as an official plan holder. All written communications with official plan holders & Contractors submitting quotes will be via email or website posting.

PUBLIC NOTICES: All notices (Notice of Award) shall be posted at the following location:

<https://www.tcl.edu/about-tcl/do-business-with-tcl/>

RIGHT TO PROTEST (SC Code § 11-35-4210): *(This only applies to contracts exceeding \$50,000.)*

Any actual bidder, offeror, contractor or subcontractor who is aggrieved in connection with this solicitation or the intended award or award of a contract under this solicitation may protest to the State Engineer in accordance with section 11-35-4210 at: CPO, Office of State Engineer, 1201 Main Street, Suite 600, Columbia, SC 29201, email: protest-ose@mso.sc.gov.

All questions & correspondence concerning this Invitation shall be addressed to the A/E.

A/E NAME: " IN-HOUSE "

A/E CONTACT: Samuel Dellorso

EMAIL: sdellorso@tcl.edu

TELEPHONE: (843) 525-8329

PRE-QUOTE CONFERENCE: Yes No

DATE: _____ TIME: _____

PRE-QUOTE PLACE: _____

QUOTE DELIVERY ADDRESSES:

HAND-DELIVERY:

Attn: Gillian Murray, Procurement

921 Ribaut Rd Bldg 3

Beaufort SC 29902

MAIL SERVICE:

Attn: Gillian Murray, Procurement

PO Box 1288

Beaufort SC 29901

IS PROJECT WITHIN AGENCY CONSTRUCTION CERTIFICATION? Yes No

APPROVED BY: _____

DATE: _____

(OSE PROJECT MANAGER)

STATEMENT OF PROBABLE CONSTRUCTION COST

7/22/2024

| TCL - Welding Lab Electrical Renovations | | | | |
|---|----------|------|------------|------------|
| Division 1 - General Conditions | Quantity | Type | Cost | Total |
| Permitting Fees | 0.00 | LS | \$0.00 | \$0.00 |
| Equipment Rental | 0.00 | LS | \$2,500.00 | \$0.00 |
| TOTAL DIVISION 1 | | | | \$0.00 |
| Division 2 - Site Work & Existing Conditions | Quantity | Type | Cost | Total |
| Demo Existing Panel Breakers and Wiring | 1.00 | LS | \$1,500.00 | \$1,500.00 |
| [SITEWORK] | | | | |
| | 1.00 | LS | \$0.00 | \$0.00 |
| TOTAL DIVISION 2 | | | | \$1,500.00 |
| Division 3 - Concrete | Quantity | Type | Cost | Total |
| | 0.00 | EA | \$0.00 | \$0.00 |
| TOTAL DIVISION 3 | | | | \$0.00 |
| Division 4 - Masonry | Quantity | Type | Cost | Total |
| | 0.00 | SF | \$0.00 | \$0.00 |
| | 0.00 | LS | \$0.00 | \$0.00 |
| TOTAL DIVISION 4 | | | | \$0.00 |
| Division 5 - Metals | Quantity | Type | Cost | Total |
| | 0.00 | SF | \$0.00 | \$0.00 |
| | 0.00 | LS | \$0.00 | \$0.00 |
| TOTAL DIVISION 5 | | | | \$0.00 |
| Division 6 - Wood, Plastics, and Composites | Quantity | Type | Cost | Total |
| Misc. Carpentry | 1.00 | LS | \$1,000.00 | \$1,000.00 |
| | 0.00 | EA | \$0.00 | \$0.00 |
| TOTAL DIVISION 6 | | | | \$1,000.00 |
| Division 7 - Thermal and Moisture Protection | Quantity | Type | Cost | Total |
| | 1.00 | LS | \$0.00 | \$0.00 |
| | 0.00 | LS | \$0.00 | \$0.00 |
| TOTAL DIVISION 7 | | | | \$0.00 |
| Division 8 - Doors and Windows | Quantity | Type | Cost | Total |
| | 0.00 | SF | \$0.00 | \$0.00 |
| | 0.00 | EA | \$0.00 | \$0.00 |
| TOTAL DIVISION 8 | | | | \$0.00 |
| Division 9 - Finishes | Quantity | Type | Cost | Total |
| | 0.00 | SF | \$0.00 | \$0.00 |
| | 0.00 | SF | \$0.00 | \$0.00 |
| | 0.00 | SF | \$0.00 | \$0.00 |
| | 1.00 | LS | \$0.00 | \$0.00 |
| | 0.00 | SF | \$0.00 | \$0.00 |
| | 0.00 | SF | \$0.00 | \$0.00 |
| TOTAL DIVISION 9 | | | | \$0.00 |
| Division 10 - Specialties | Quantity | Type | Cost | Total |
| | 0.00 | LS | \$0.00 | \$0.00 |
| | 0.00 | LS | \$0.00 | \$0.00 |
| TOTAL DIVISION 10 | | | | \$0.00 |
| Division 11 - Equipment | Quantity | Type | Cost | Total |
| | 0.00 | EA | \$0.00 | \$0.00 |
| | 0.00 | LS | \$0.00 | \$0.00 |
| TOTAL DIVISION 11 | | | | \$0.00 |
| Division 12 - Furnishings | Quantity | Type | Cost | Total |
| | 1.00 | EA | \$0.00 | \$0.00 |
| TOTAL DIVISION 12 | | | | \$0.00 |
| Division 13 - Special Construction | Quantity | Type | Cost | Total |
| | 0.00 | EA | \$0.00 | \$0.00 |
| | 0.00 | LS | \$0.00 | \$0.00 |
| TOTAL DIVISION 13 | | | | \$0.00 |
| Division 14 - Conveying Equipment | Quantity | Type | Cost | Total |
| | 0.00 | LS | \$0.00 | \$0.00 |
| | 0.00 | LS | \$0.00 | \$0.00 |
| TOTAL DIVISION 14 | | | | \$0.00 |

| Divison 21 - Fire Suppression | | Quantity | Type | Cost | Total |
|---|--|----------|------|------------|-------------|
| | | 0.00 | LS | \$0.00 | \$0.00 |
| | | 0.00 | LS | \$0.00 | \$0.00 |
| TOTAL DIVISION 21 | | | | | \$0.00 |
| Divison 22 - Plumbing | | Quantity | Type | Cost | Total |
| Plumbing | | 1.00 | LS | \$0.00 | \$0.00 |
| | | | | | |
| TOTAL DIVISION 22 | | | | | \$0.00 |
| Divison 23 - HVAC | | Quantity | Type | Cost | Total |
| HVAC | | 1.00 | LS | \$0.00 | \$0.00 |
| | | 1.00 | LS | \$0.00 | \$0.00 |
| TOTAL DIVISION 23 | | | | | \$0.00 |
| Divison 26 - Electrical | | Quantity | Type | Cost | Total |
| New Breakers for 400 amp panel | | 1.00 | LS | \$9,000.00 | \$9,000.00 |
| New 100 amp subpanel | | 1.00 | LS | \$7,500.00 | \$7,500.00 |
| Connections to hoods and welding stations | | 1.00 | LS | \$5,000.00 | \$5,000.00 |
| | | 1.00 | LS | | \$0.00 |
| | | 1.00 | LS | | \$0.00 |
| | | 1.00 | LS | | \$0.00 |
| TOTAL DIVISION 26 | | | | | \$21,500.00 |
| Divison 27 - Communications | | Quantity | Type | Cost | Total |
| | | 0.00 | LS | \$0.00 | \$0.00 |
| | | 0.00 | LS | \$0.00 | \$0.00 |
| TOTAL DIVISION 27 | | | | | \$0.00 |

| | |
|-------------------------------|--------------------|
| Total 1-14 | \$2,500.00 |
| Sprinklers and Plumbing | \$0.00 |
| HVAC | \$0.00 |
| Electrical and Communications | \$21,500.00 |
| +10% Overhead | \$2,400.00 |
| +10% Contractor Fee | \$2,640.00 |
| +20% Contingency | \$5,808.00 |
| TOTAL CONSTRUCTION | \$34,848.00 |

| | |
|-------------------------|--------|
| RECOMMENDED FFE BUDGET: | \$0.00 |
|-------------------------|--------|

| | |
|---|----|
| Exi: Bracket Base_2-6 x 7-0_4 Inch: Bracket Base_2-6 x 7-0_4 Inch | 29 |
| Cur Bracket Base_3-0 x 3-0: Bracket Base_3-0 x 3-0 | 8 |
| Bracket Base_4-0 x 10-0: Bracket Base_4-0 x 10-0 | 31 |
| Exi: Bracket Base_5-0 x 10-0: Bracket Base_5-0 x 10-0 | 1 |
| Cur Elevator_10913: Passenger_2500 | 1 |
| OPENING TRIM_SIMPLE: 3.5" TRIM - 3.5" BASE | 12 |
| Exi: ROOF TOP TRIM: ROOF TOP TRIM | 1 |
| Cur Grand total: 84 | 84 |

Grand total: 480



TECHNICAL COLLEGE OF
THE LOWCOUNTRY
921 RIBAUT ROAD
BEAUFORT, SC 29901

| REV# | DESCRIPTION | DATE |
|------|-------------|------|
| | | |
| | | |
| | | |
| | | |
| | | |

This drawing is the property of Architecture 101, LLC and may not be reproduced or copied without written permission. Reference notes as indicated on drawings. Do not scale drawings. Consult the Architect for necessary clarification.



FOR CONSTRUCTION

WALL LEGEND

EXISTING



NEW CONSTRUCTION



DEMO NOTES

1. See Electrical notes

GENERAL NOTES

1. All wall types Type 'A' unless noted otherwise.



First Floor Plan

| | |
|----------------|-------------|
| 2024.29 | A102 |
| 7/22/2024 | |
| Drawn By JAT | |
| Checked By SGS | |

7/22/2024 11:37:50 AM

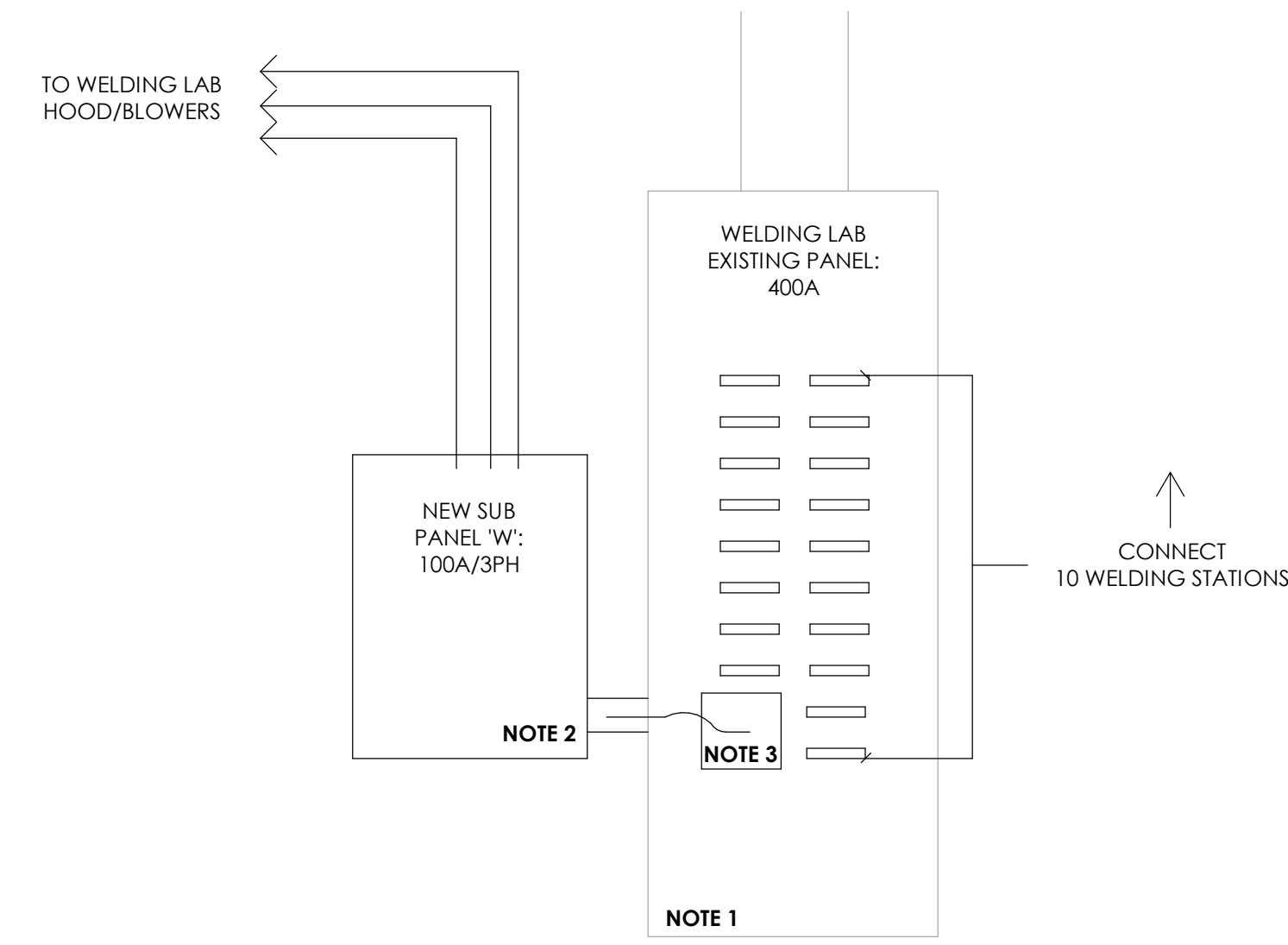

ELECTRICAL NOTES:

NOTE 1: ADD (10) 50A/2 POLE BREAKERS CONNECT TO MILLER 300 WELDING STATIONS. (STATIONS BY OWNER)

NOTE 2: PROVIDE 100A/3 POLE TO POWER SUB PANEL 'W'.

NOTE 3: PROVIDE (5) 40A/3PH TO WELDING LAB HOODS.

DEMO NOTE: DEMO ALL EXISTING PANEL CIRCUITS IN EXISTING WELDING LAB PANEL.

WELDING LAB PANEL DETAIL
1" = 1'-0"

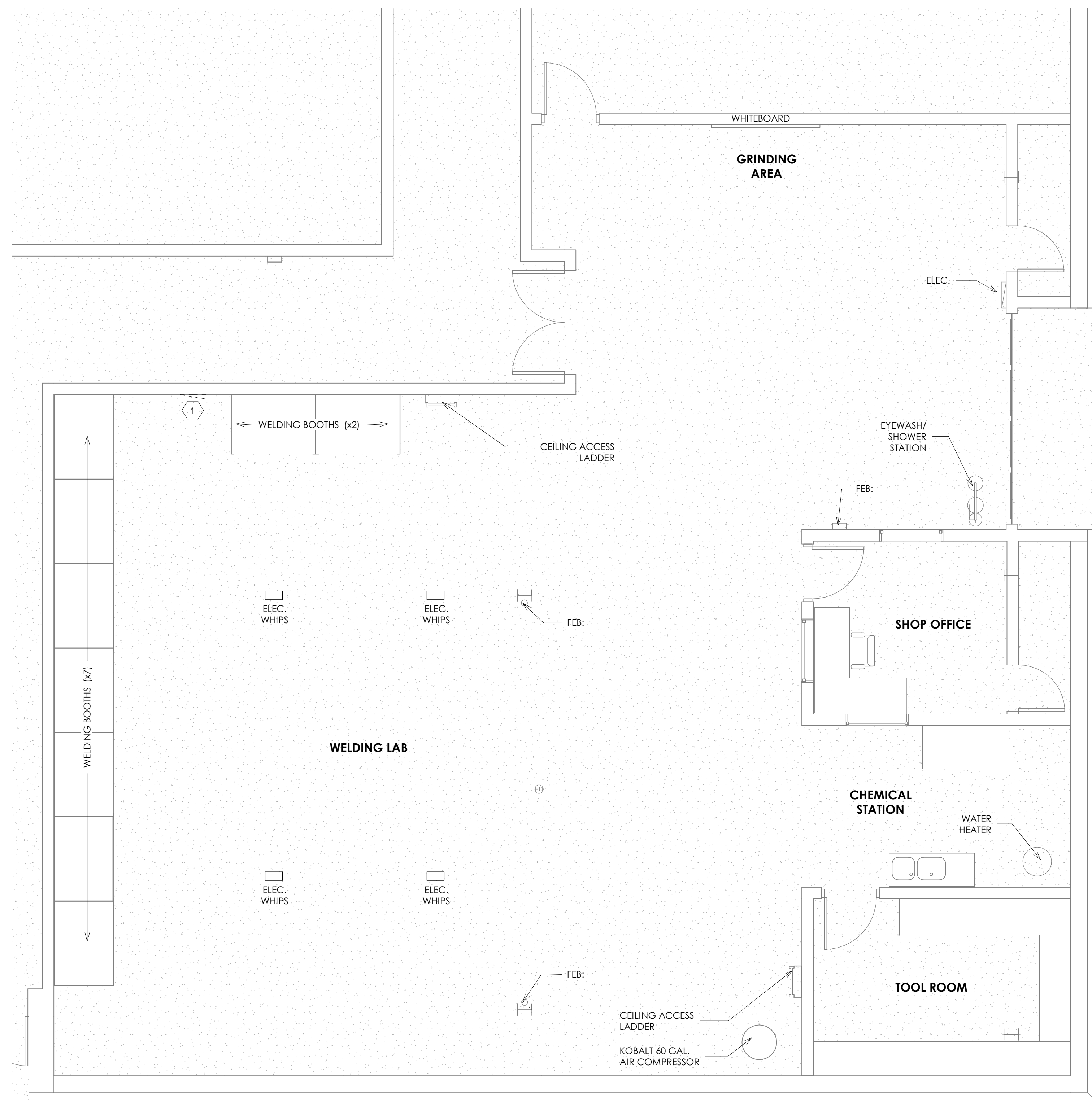

WELDING LAB FIRST FLOOR EXISTING AND DEMO
1/4" = 1'-0"

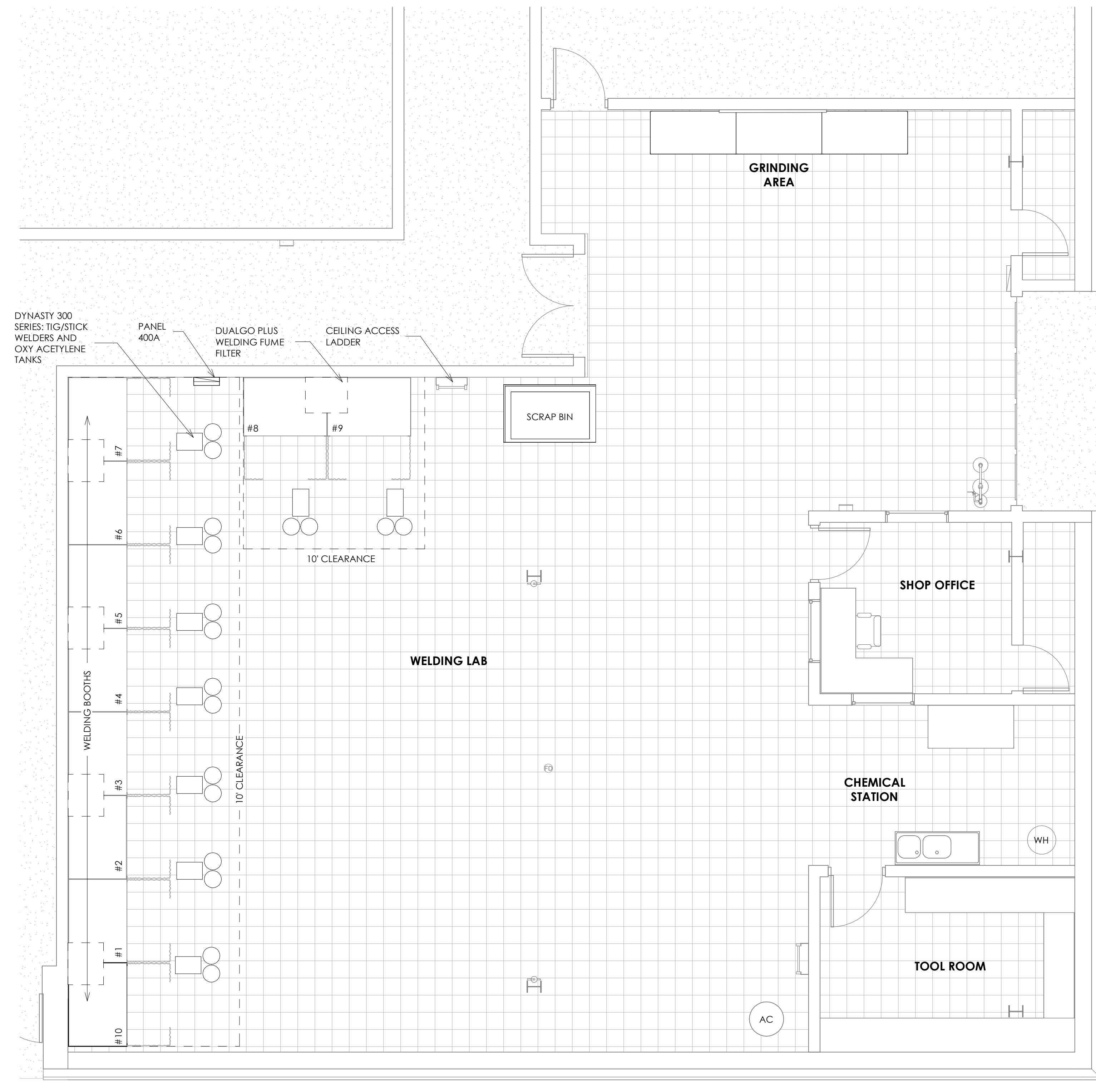

WELDING LAB FIRST FLOOR
1/4" = 1'-0"

TECHNICAL COLLEGE OF THE LOWCOUNTRY WELDING LAB ELECTRICAL RENOVATIONS

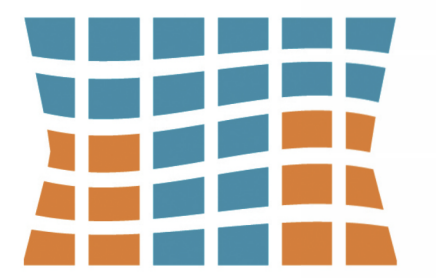

TECHNICAL COLLEGE OF
THE LOWCOUNTRY
921 RIBAUT ROAD
BEAUFORT, SC 29901

| REV# | DESCRIPTION | DATE |
|------|-------------|------|
| | | |
| | | |
| | | |
| | | |
| | | |

This drawing is the property of Architecture 101, LLC and may not be reproduced or copied without written permission. Reference notes as indicated on drawings. Do not scale drawings. Consult the Architect for necessary clarifications.



FOR CONSTRUCTION

PROPERTY INFORMATION

ADDRESS: 921 RIBAUT ROAD,
BEAUFORT, SC 29901

PIN: R120 005 000 0102 0000

CONTACT INFORMATION

ARCHITECT - ARCHITECTURE 101
CONTACT: JENIFER TORRES
ROLE: PROJECT MANAGER
PHONE: (956) 478-2747
EMAIL: Jen@a101.design

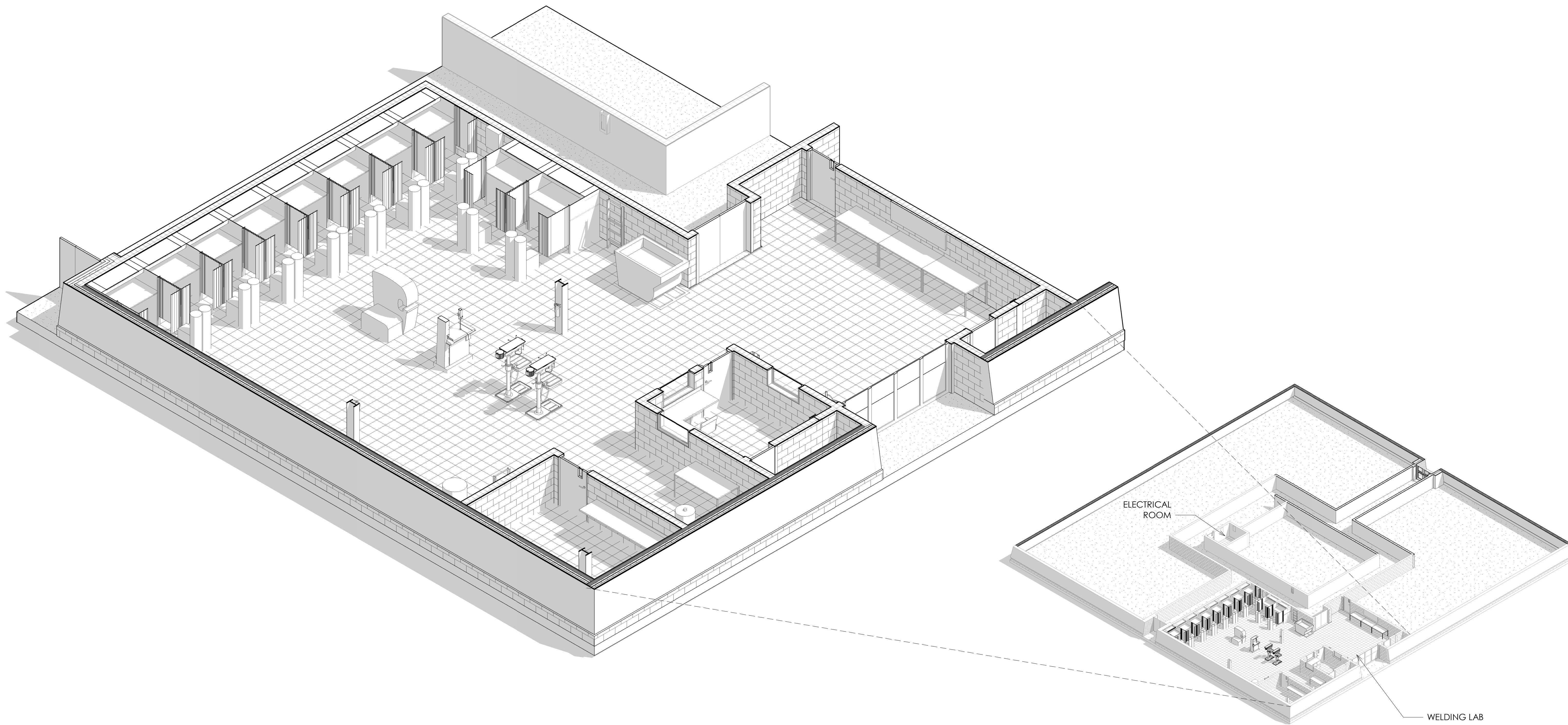

DRAWING INDEX

| Sheet Number | Sheet Name | Sheet Issue Date |
|----------------------|------------------|------------------|
| General | | |
| G000 | COVER SHEET | 7/22/2024 |
| Architectural | | |
| A102 | First Floor Plan | 7/22/2024 |

LOCATION MAP



VICINITY MAP



ABBREVIATIONS

| | | | |
|-------|--------------------------|-------|---------------------|
| APC | ACOUSTICAL PANEL CEILING | MAX | MAXIMUM |
| AFF | ABOVE FINISH FLOOR | MFR | MANUFACTURER |
| AC | AIR COMPRESSOR | MIN | MINIMUM |
| AHU | AIR HANDLING UNIT | MISC | MISCELLANEOUS |
| CJ | CONTROL JOINT | MIO | MASONRY OPENING |
| CL | CENTERLINE | N/A | NOT APPLICABLE |
| CLG | CEILING | NIC | NOT IN CONTRACT |
| CMU | CONCRETE MASONRY UNIT | NIS | NOT TO SCALE |
| CONT | CONTINUOUS | OC | ON CENTER |
| CT | CERAMIC TILE | OPH | OPPOSITE HAND |
| DIA | DIAMETER | OSB | ORIENTED STRAND BD. |
| DIM | DIMENSION | PERF | PERFORATED |
| DN | DOWN | PT | PRESSURE TREATED |
| DS | DOWNSPOUT | REQ'D | REQUIRED |
| DW | DISHWASHER | SF | SQUARE FEET |
| EA | EACH | SIM | SIMILAR |
| EQ | EQUAL | SPEC | SPECIFICATION |
| EQUIP | EQUIPMENT | STD | STANDARD |
| EXT | EXTERIOR | TBD | TO BE DETERMINED |
| FD | FLOOR DRAIN | T&G | TONGUE & GROOVE |
| FF | FINISH FLOOR | TEMP | TEMPORARY |
| FFE | FINISH FLOOR ELEV. | TV | TELEVISION |
| FIN | FINISH | TYP | TYPICAL |
| FT | FEET | U/C | UNDER COUNTER |
| GA | GAUGE | W/D | WASHER/DRYER |
| GWB | GYPSUM WALLBOARD | WD | WOOD |
| HB | HOSE BIBB | WH | WATER HEATER |
| INT | INTERIOR | | |



COVER SHEET

| | |
|-----------------|-------------|
| 2024.29 | G000 |
| 7/22/2024 | |
| Drawn By: JAT | |
| Checked By: SGS | |